

LM-ProPower AirLED QuickGuide

LM

feel the difference

DVD: 

Air polisher

Control panel:

To **turn on the polisher**, press **ON** and then choose the working mode:

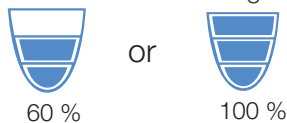

With every push on the **ON** key, the function toggles from:

1. Normal polishing
2. Air cleaning (only air)
3. WaterJet cleaning (only water and air)

The unit is **standby** when the power cord is connected and the green LED is illuminated.

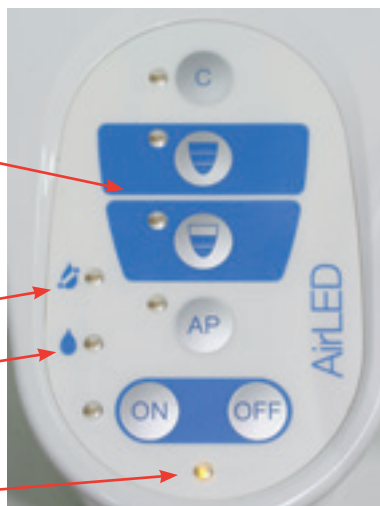

Air purge quick cleaning function:

To prevent clogging; air purge the handpiece after each polisher treatment by pressing **AP**.

Comprehensive cleaning function:

Press **C** -key to start the cleaning. Water or desinfectant (40 sec) and air (40 sec) cleans the handpiece. The cleaning cycle stops automatically after **80 seconds**.

To switch off the polisher press the **OFF** -key.

Water regulation:

Depress the foot control and slowly reduce the water flow with the water control wheel on the side of the powder container until the powder starts to accumulate on the surface as a white spot. Increase the water flow until the spot disappears. The polisher is now balanced for optimal performance.



Foot control:

The polisher is **activated** when the foot control is pressed down. The polishing power is regulated from: left/ZERO = WaterJet (only water and air) middle & right/MAX = 60 or 100% depending on which working mode is chosen on the control panel.

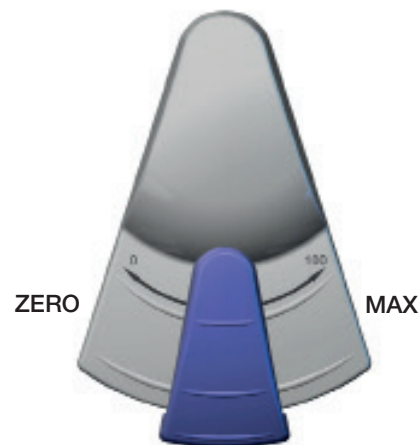
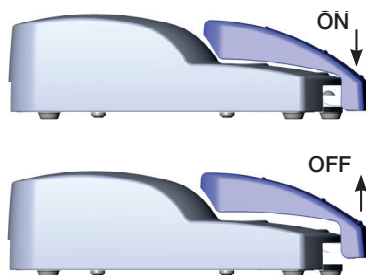

LM-ProPower AirLED Installation

NOTE! Before installing and using the device please read the manual.

1. Consult a qualified technician to install to air and, if applicable, to water supply.
2. Connect the foot control cable to the foot control and to the rear side of the unit.
3. Connect the power cord to the unit and the AC power outlet.

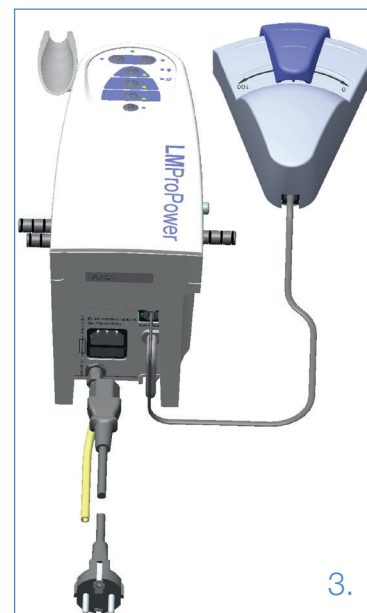
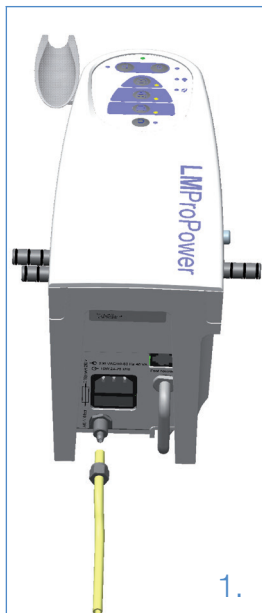

4. Fill the medicament bottle with water or medicament solution, screw the bottle connector onto the bottle and push it onto the connector on the left side.

5a. Unscrew the powder container from the cap and fill with LM-ProPower polisher powder up to MAX. Screw the container back to the cap.

5b. Connect the powder container to the connectors on the right side of the unit.



6. Gently slide a LM-ErgoGrip onto the polisher handpiece. Screw the nozzle clockwise into the polisher handpiece until the nozzle is firmly tightened up.

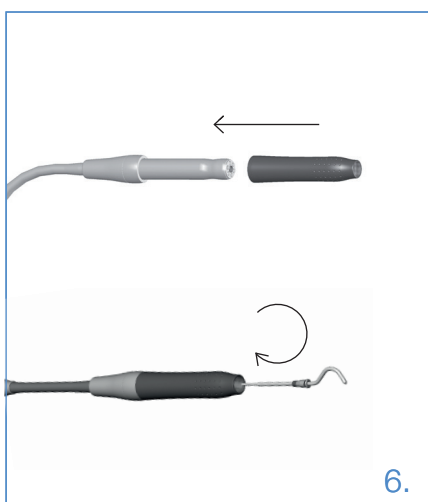

7. See the **operational instructions** in the manual.



LMDental
LM-Instruments Oy
Norbyn rantatie 8
FI-21600 Parainen
Finland
+358 2 4546 400
info@lm-dental.com
www.lm-dental.com

0517_9770397B